

FOUNDATION PLAN

1/8" = 1'-0"

QTY	SIZE	THED LENGTH	EP	BAR MARK	BND V	BND TOP	CD	BENDING DIMENSIONS														
								A	B	C	D	E	F/R	G	H	J	K	L				
4	6	4-06	6A3					1-00	3-06													
10	6	4-08	6A5					1-00	3-08													
24	6	3-00	6A9					1-00	2-00													
16	5	4-07	5A1					0-10	3-09													
17	5	4-00	5A11					2-00	2-00													
20	5	4-11	5A13					1-06	3-05													
9	5	6-01	5A14					2-00	2-01	2-00												
125	5	6-04	5A15					1-06	4-10													
70	4	4-02	4A12					0-08	3-06													
16	3	3-08	3A2					0-04	0-07	0-11	0-07	0-11										
4	3	7-04	3A4					0-04	1-08	1-08	1-08	1-08										
4	3	7-08	3A6					0-04	1-08	1-10	1-08	1-10										
16	3	2-04	3A7					0-04	1-08													
4	3	6-00	3A8					0-04	1-00	1-08	1-00	1-08										
12	3	6-04	3A10					0-04	1-02	1-08	1-02	1-08										
160	7	6-06																				
56	7	4-06																				
20	6	2-06																				
14	5	23-08																				
3	5	23-06																				
5	5	23-00																				
7	5	21-00																				
138	5	20-00																				
9	5	19-08																				
7	5	19-06																				
5	5	11-08																				
20	5	6-02																				
148	5	4-06																				

FOOTING SCHEDULE

LABEL	RO	PL	QTY	PLAN LOCATION: FND	SIZE	LENGTH	BARMARK	PLACING NOTES
F1A	8			Cross Ref.: F1A				1'-0" x 7'-0" x 18"
			2x	SECTION: FTR	7	6-06		Ø9"EW-BTM
F2B	4			Cross Ref.: F2B				5'-0" x 5'-0" x 15"
			2x	SECTION: FTR	7	4-06		Ø9"EW-BTM
F5C	2			Cross Ref.: F5C				3'-0" x 3'-0" x 12"
			2x	SECTION: FTR	5	6-06		Ø9"EW-BTM

PIER SCHEDULE

LABEL	RO	PL	QTY	PLAN LOCATION: FND	SIZE	LENGTH	BARMARK	PLACING NOTES
PA	4			Cross Ref.: PA				10' x 12' PIER
			4	SECTION: PIER	5	5A1		DWLØFTG
			4		3	3A2		Ø12" TIES
PB	1			Cross Ref.: PB				24" x 24" PIER
			4	SECTION: PIER	6	6A3		DWLØFTG
			4		3	3A4		Ø12" TIES
PC	1			Cross Ref.: PC				24" x 24" PIER
			6	SECTION: PIER	6	6A5		DWLØFTG
			4		3	3A6		Ø12" TIES
			4		3	3A7		Ø12" TIES
PD	1			Cross Ref.: PD				16" x 24" PIER
			4	SECTION: PIER	6	6A5		DWLØFTG
			4		3	3A8		Ø12" TIES
PE	4			Cross Ref.: PE				18" x 24" PIER
			6	SECTION: PIER	6	6A9		DWLØFTG
			3		3	3A10		Ø12" TIES
			3		3	3A7		Ø12" TIES

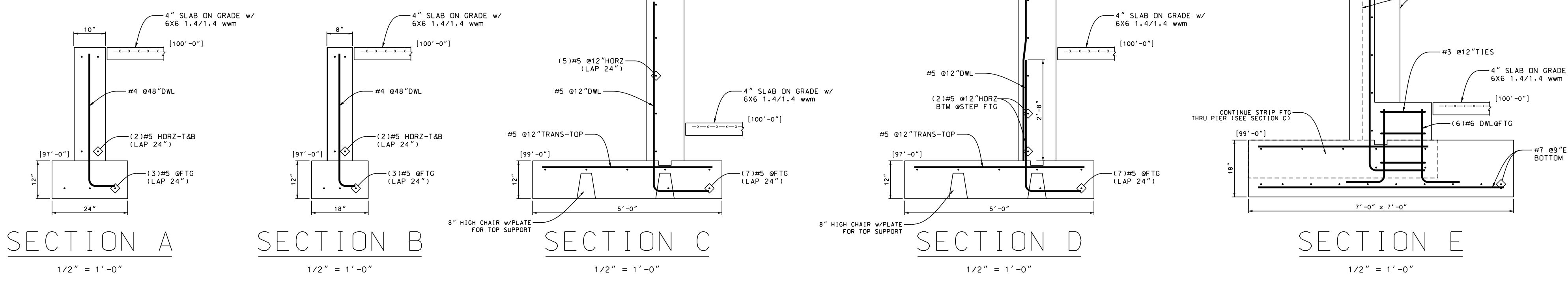
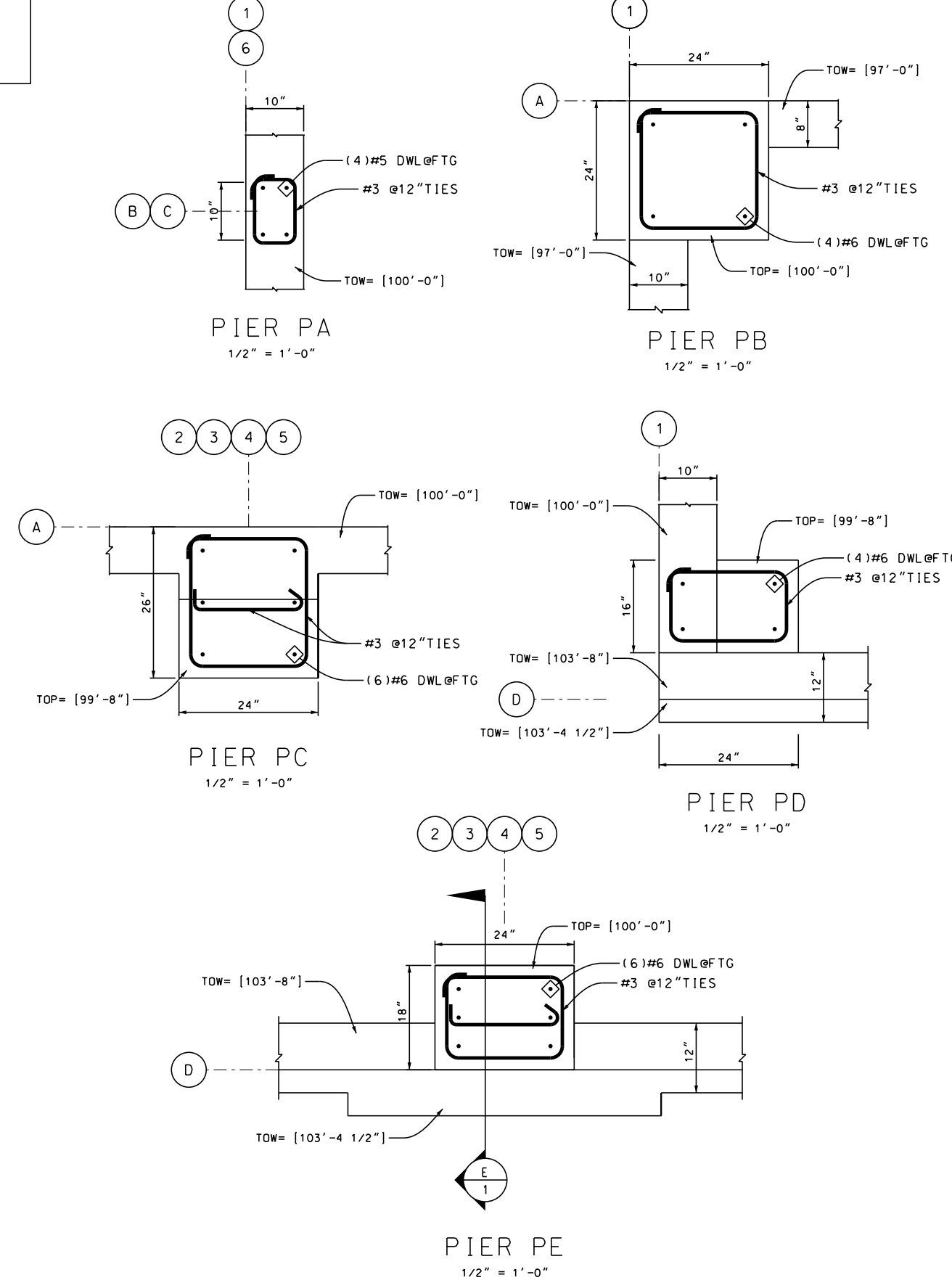

REV	DATE	DESCRIPTION	10-1-14	APPROVAL
		DATE		SENT FOR
11 TURNER DRIVE SPENCERPORT, NY 14559 TEL: 585-352-9433 FAX: 585-352-4474 KLEIN@FRONTIER.NET		FOUNDATION PLAN		
BAR LAP EQUIV: •13mm = #4 - 1/2" •16mm = #5 - 5/8" •19mm = #6 - 3/4" •22mm = #7 - 7/8" •25mm = #8 - 1" •29mm = #9 - 1-1/8" •32mm = #10 - 1-1/4"		DRAWING COVERS STRUCTURE: DOLLAR GENERAL LOCATION: BLOOMFIELD, NY ENG./ARCH: OPPENHUIZEN ARCHITECTS CUSTOMER: AEY ENTERPRISES DETAILER: MHK GRADE: 60		
		JOB NO.: 858-14 DATE: 10-1-14		DRWG. NO. 1