

### Wire Baskets (without Dowels)

Dowel Baskets without dowels are available for contraction and expansion joints in slabs 4" to 9" thick. These are fabricated for 3/4", 1", or 1-1/4" diameter dowels as required.

Type "D" Contraction Baskets and K-5 Type "D" Expansion Baskets are a standard 10" width.

Note: Dowel Bars, Dowel Caps, Basket Clips, and Basket Stakes are sold separately.

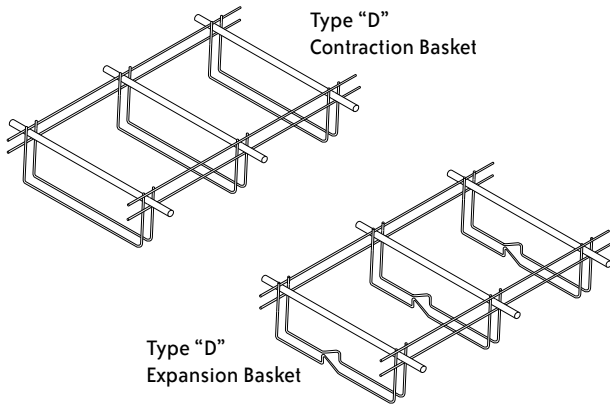

Cat I.D.	Part #	Description	Weight/Piece
<i>K-4 Type "D" Contraction Style</i>			
K-4	81102	Legs @ 12" Ctrs	.081
K-4	81104	Legs @ 15" Ctrs	.075
K-4	81106	Legs @ 18" Ctrs	.071
K-4	81108	Legs @ 24" Ctrs	.066
K-4	80928	Legs @ 30" Ctrs	.063
<i>K-5 Type "D" Expansion Style</i>			
K-4	81112	Legs @ 12" Ctrs	.085
K-4	81114	Legs @ 15" Ctrs	.079
K-4	81116	Legs @ 18" Ctrs	.075
K-4	81118	Legs @ 24" Ctrs	.070
K-4	80929	Legs @ 30" Ctrs	.067

### Tie Bar Assembly

Tie bar assembly is a basket supporting and positioning rebar dowels of various sizes as specified by the owner of the paving. It is commonly used for longitudinal joints in both DOT and commercial applications. Available in plain or epoxy coated. Call for special pricing.

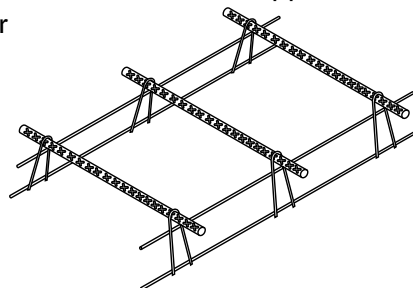

### Double Vee Load Transfer Device

The Double Vee LTD is designed for load transfer restoration in concrete pavement joints. It prevents vertical slab movement while allowing the necessary horizontal movement during load transfer. The Double Vee is manufactured with stainless steel and a flexible, polyurethane foam insert. Priced On Application.

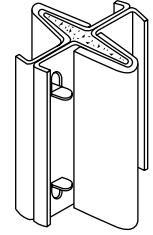

### Dowel Bars

Dowel bars available in many different diameters and lengths. Specify plain, painted or epoxy. Other options include: patched ends, tectyl bond-breaker, fully or 3/5 painted, square, or round.

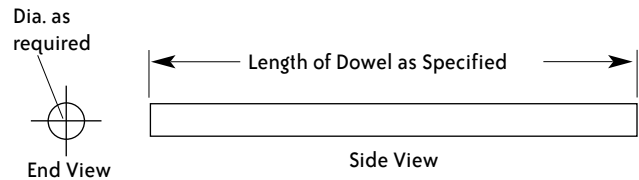

Cat. I.D.	Part #	Description (Plain) (Dia. & Length)*	Pcs/Pkg	Weight/Piece
F-38	D03239	1/2" x 18"	1500	1.00
F-38	D03074	5/8" x 18"	1000	1.57
F-38	D02143	3/4" x 18"	800	2.25
F-38	D03228	1" x 18"	400	4.01
F-38	D03253	1 - 1/4" x 18"	300	6.26
F-38	D03052	1 - 1/2" x 18"	200	9.01
F-38	D2124G60	2" x 24"	100	21.36

Add \$.12/pc for Tectyl Bondbreaker.

\*Diameters and Lengths not shown on above table are also available from AHT